

## TYPE **RP400** DN 65-100

**Carbon Steel ASTM A 216 WCB**  
**Flanged ANSI B16.5 150 RF – 300 RF**

**Face to face ASME / ANSI B16.10**

### DESCRIPTION

Type RP14 pressure reducing valve is a self-actuated proportional action type.

Composed by a direct action single seat special body valve, flow tries to open with a balanced internal system, diaphragm and feedback spring, controlled by downstream pressure.

The Internal balance with piston and pure graphite + antimony ring, without bellow, guarantees a long life to the valve, with the possibility of long term maintenance.

The action flow opens the plug guarantees, in these large diameters, a fluid proportional action.

Can be easily installed, is suitable on industrial plants where compressed air is not available for a "pneumatic reducing system" or where the user requires a fixed reduced pressure not subjected to frequent variations.

#### SIZES :

from DN 65 to DN 100

#### MAX WORKING CONDITIONS :

Maximum inlet pressure with Steam or Air	23 bar
Maximum design temperature	220 °C
Maximum downstream reduced pressure (1)	8 bar
Minimum downstream reduced pressure	0,2 bar

#### ON REQUEST :

- PTFE/GR Soft seal ≤190°C class VI°
- PTFE Soft seal ≤150°C class VI°
- Stellite seat and plug grade 6 (recommended with  $\Delta p \geq 12$  bar)
- Reduced bore (see table)

**CV=unità americane (portata in GPM con 1 psi di pressione differenziale)**

#### CONNECTIONS :

CORPO : flanged ANSI B 16.5 150 RF - 300 RF  
on request AA 125-RH

ACTUATOR : screwed Rp ISO 7 - Rp 3/8"

#### CAMPI DI RIDUZIONE :

TIPO	TESTATA rif.	CAMPO bar
<b>C1</b>	T60	3 - 8
<b>C2</b>	T80	1 - 5
<b>C3</b>	T100	0,5 - 3
<b>C5</b>	T150	0,2 - 1,5
(1) C1 speciale	T50	8 - 12 bar

#### REDUCED PRESSURE RANGE :

- KIT for STEAM in carton box (**weight 2,2 Kg**) : pot (2,3 lt), cap, fittings and spring adj. tool
- KIT for AIR in plastic bag (**weight 0,2 Kg**) : fittings and spring adjusting tool



**CV=american unit (flowrate in GPM with 1 psi of differential pressure)**

PLUGS PT cl. IV° Full bore	DIAMETRO NOMINALE			
	DN 65	DN 80	DN 100	
	Ø 2.1/2"	Ø 3"	Ø 4"	
<b>CV</b>	<b>46,07</b>	<b>72,59</b>	<b>101,24</b>	
<b>KV</b>	<b>39,85</b>	<b>62,80</b>	<b>87,58</b>	
Rangeability	1:22	1:22	1:22	
Reduced bore	Not applicable	Ø 2.1/2"	Ø 2.1/2"	Ø 3"
<b>CV</b>	-	<b>46,07</b>	<b>46,07</b>	<b>72,59</b>
<b>KV</b>	-	<b>39,85</b>	<b>39,85</b>	<b>62,80</b>
Rangeability	-	1:22	1:22	1:22

NOTE : The downstream pipe diameter must be sized according to the specific volume of steam reduced pressure, to obtain a steam velocity not exceeding 30-35 m/s (maximum limit value = 40 m/s).

# COMPONENTS LIST and MATERIALS

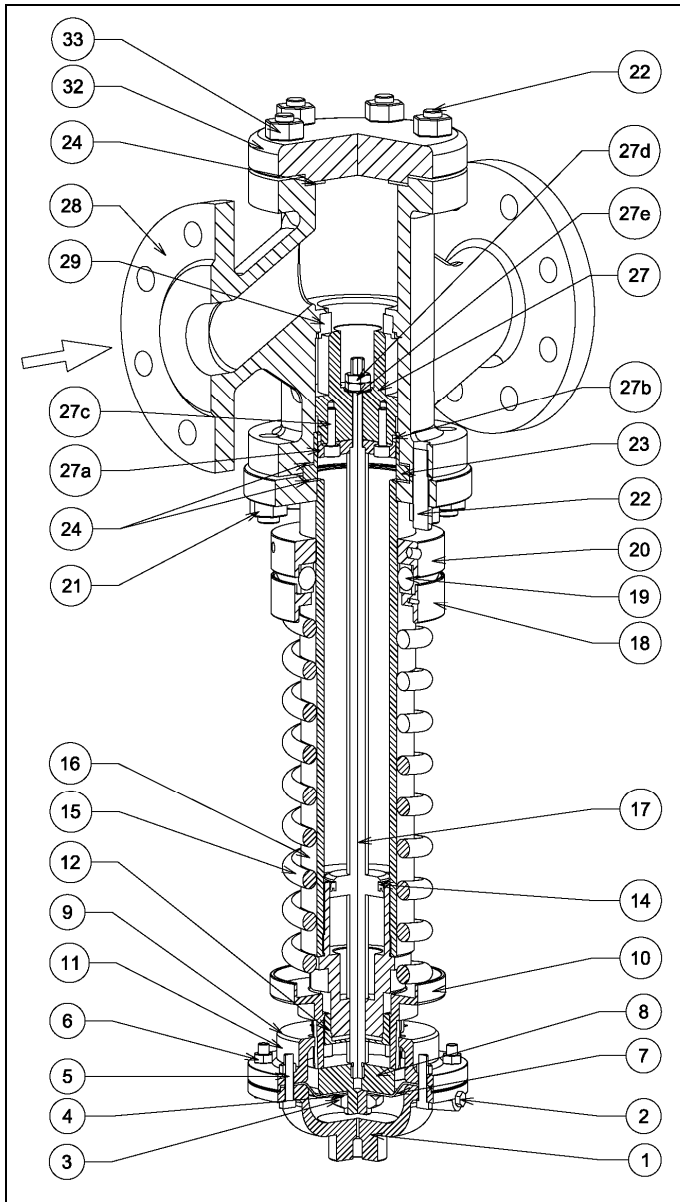

## COMPONENTS LIST

1. Upper diaphragm casing
2. Airvent screw
3. Diaphragm locknut
4. Washer
5. Diaphragm casing bolts
6. Dadi serraggio testata
7. Diaphragm
8. Diaphragm plate
9. Lower diaphragm casing
10. Lower spring plate
11. Grub screw
12. Airtight guide
14. Corteco
15. Spring
16. Yoke
17. Stem
18. Upper spring plate
19. Ball bearing
20. Spring adjusting plate
21. Body locknuts
22. Stud bolts
23. Plug guide ring
24. Body gaskets
27. Piston plug
- 27a. Piston upper plate
- 27b. Seal ring
- 27c. Plug locking screw
- 27d. Plug locking locknuts
- 27e. Plug washer
28. Body
29. Seat
32. Lower flange
33. Lower flange locknuts

## MATERIALS

1. Cast iron EN-GJL-250
2. 4.8 DIN 933 galvanized st.
3. AISI 304 St. steel
4. DIN 125 galvanized steel
5. 8.8 DIN 933 galvanized st.
6. ISO 4033 galvanized steel
7. RubbertexT60-80 ( on request spec. Material for mineral oil.)  
NBR T100-150
8. Steel A105
9. Cast iron EN-GJL-250
10. Bronze UNI 7013-72
11. Steel 14.9 DIN 914
12. OT58 Brass
14. NBR DIN 3760
15. 52SiCrNi5 (DN65-100)
16. A105 nichel plated.
17. AISI 304 St. steel
18. AVP galvanized
19. Steel Rif. 51118
20. AVP galvanized
21. ISO 4033 galvanized steel
22. Automatic galvanized st.
23. AISI 316 St. steel
24. Centellen WS 3820  
On request PTFE
27. AISI 316 St. steel
- 27a. AISI 316 St. steel
- 27b. EK3245
- 27c. 14.9 DIN 914 steel
- 27d. ISO 4033 galvanized steel
- 27e. DIN 125 galvanized steel
28. Carbon steel 1.0619
29. AISI 316 St. steel
32. ASTM A105 steel
33. ISO 4033 galvanized steel

## SPARE PARTS KIT

### Diaphragm + Plate ( ref. 3-4-7-8 )

T.50 cod. JMRP13T050RSTD  
T.60 cod. JMRP13T060RSTD  
T.80 cod. JMRP13T080RSTD

### Diaphragm + Plate ( ref. 3-4-7-8 )

T.100 cod. JMRP13T100RSTD  
T.150 cod. JMRP13T150RSTD

### Gaskets kit [ ref. 14-24 ]

cod. JRP13TG065080FB-0  
cod. JRP13TG100000FB-0

## DIMENSIONS (mm) and weight in Kg.

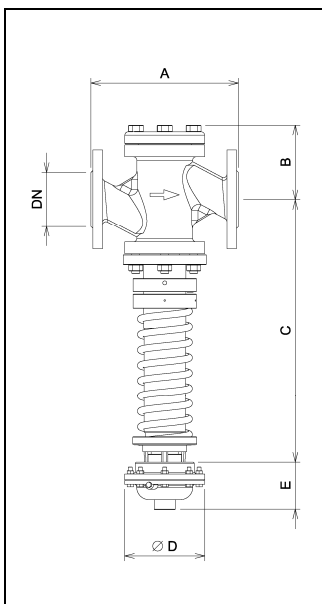

### Body groups

DN	Ø	A	B	C	Weight Kg
65	2.1/2" A150RF	292	148	535	48,7
	2.1/2" A300RF				50,7
80	3" A150RF	317	148	568	52,9
	3" A300RF				57,1
	4" A150RF				368
4" A300RF	84,6				

### Actuators

Type	Ø D	E	Weight Kg
T60	149	94	3,8
T80	162	94	4,8
T100	188	96	6,0
T150	226	93	7,9

For valve sizing, see leaflet 100/VP Part I\*

Specifications given are only indicative and not binding for the manufacturer who reserve the right to carry-out any modifications deemed necessary without prior notice. All data sheets by CONFLOW SpA, are available last update on our internet web site [www.conflo.it](http://www.conflo.it).