

**-Specifications-**

Input Signal	4-20mA @ 24VDC
Input Resistance	425Ω
Air Supply	3 - 7 bar (100 psi) free of oil, water, and moisture
Standard Stroke	30 mm - 300 mm
Pneumatic Connections	Rc 1/4 or NPT 1/4
Electrical Connections	G 1/2 or NPT 1/2
Protection Class	Exd IIC T6
Ambient Temperature	-20 - + 70 °C
Output Characteristics	Linear
Linearity	Within ±1.0 % F.S
Sensitivity	Within ±0.5 % F.S
Hysteresis	Within 1.0 % F.S
Repeatability	Within ±0.5 % F.S
Air Consumption	5 LPM (Sup. 1.4 bar)
Material	Aluminum die-cast
Weight	2kg

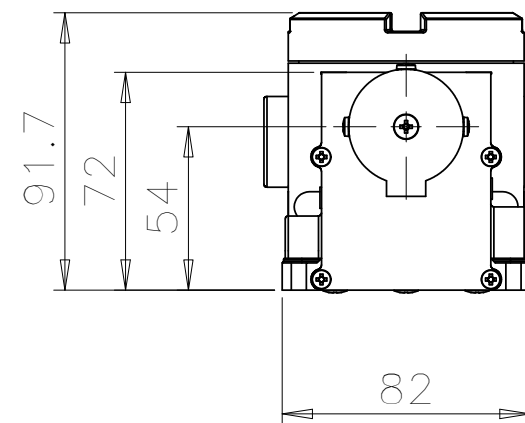
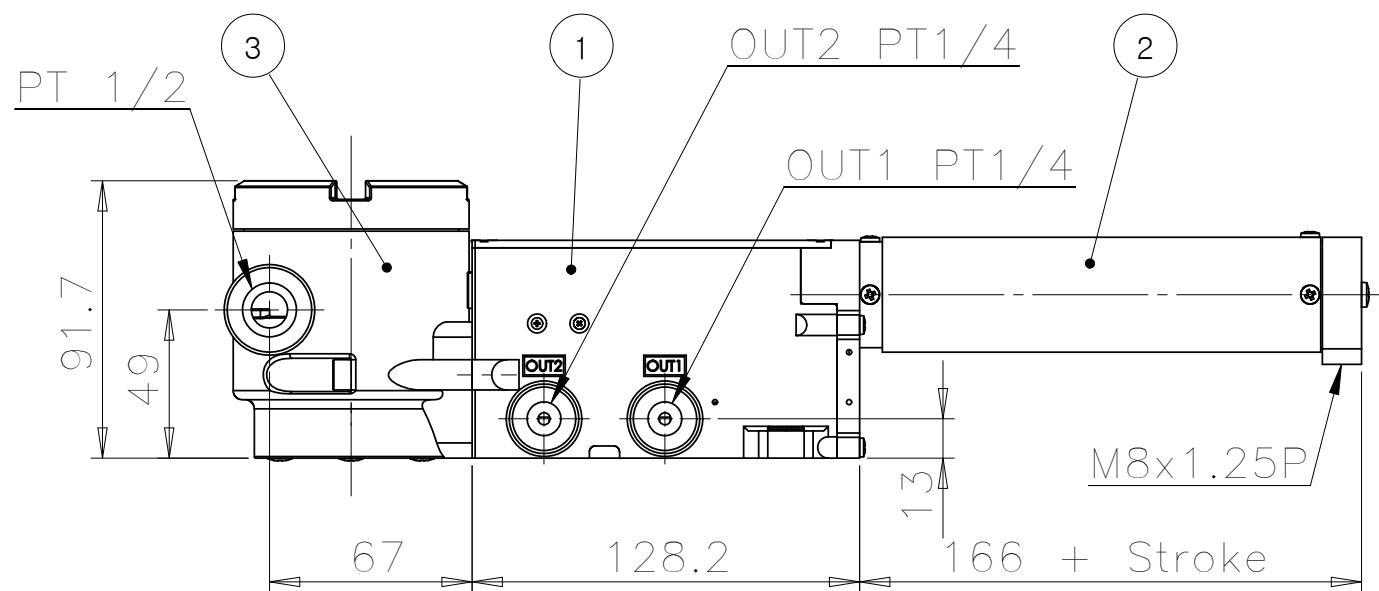

	PART NAME	MATERIAL	Q'TY	REMARK
1	BODY	AL DIECASTING	1	
2	CYLINDER	AL DIECASTING	1	
3	TERMINAL BOX	AL DIECASTING	1	
4	COVER	AL DIECASTING	1	

<b>PG POWER-GENEX</b> http://www.power-genex.com				TITLE: EPCL OUTLINE	
DRAWN	NAME	SIGNATURE	PROJ :	PRODUCT NAME: ELECTRIC PNEUMATIC CYLINDER POSITIONER	
CHECKED	Ko. S. W		3rd	MODEL: EPCL	
APPROVED	Ko. S. Y		SCALE: 1:2.5	DWG. NO. PG-EPCL-02a	
DATE	September, 2008			REV. NO. A	
QUANTITY	DIMENSION : mm				
	SHEET 1 OF 2				