

REV. NO.	REVISION DESCRIPTION	DATE	APPROVED
A			

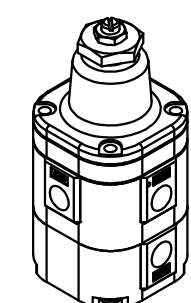
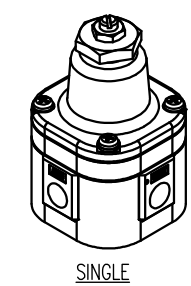
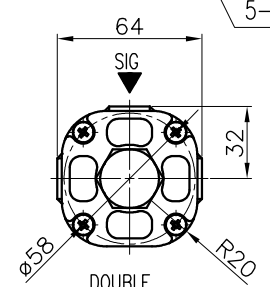
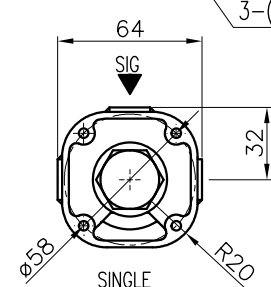
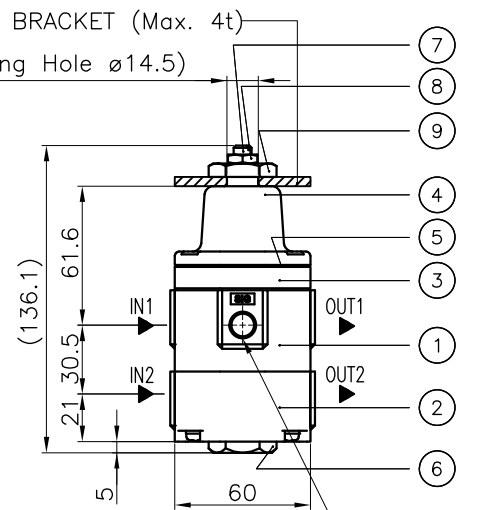
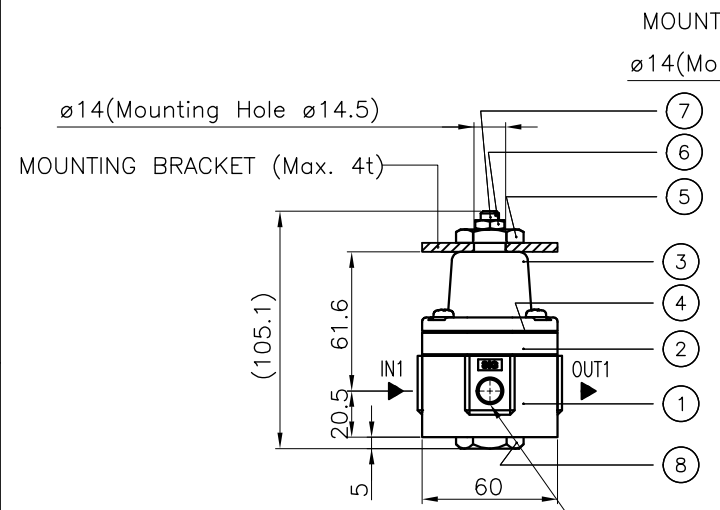

SINGLE

No.	Part name	Material
1	Upper Body	ALDC 12.1
2	Exhaust ring	ALDC 12.1
3	Spring case	ALDC 12.1
4	Diaphragm	NBR
5	Mounting Nut	SUS304
6	Adjust screw fix Nut	SUS304
7	Adjust screw	SUS304
8	Drain plug	BRASS

DOUBLE

No.	Part name	Material
1	Upper Body	ALDC 12.1
2	Lower Body	ALDC 12.1
3	Exhaust ring	ALDC 12.1
4	Spring case	ALDC 12.1
5	Diaphragm	NBR
6	Drain plug	BRASS
7	Adjust screw	SUS304
8	Adjust screw fix Nut	SUS304
9	Mounting Nut	SUS304

-SPECIFICATIONS

LU		
Model	LUS	LUD
Proof Pressure	Max 10 bar (150 psi)	
Signal pressure	1.4 ~ 7 bar	
Line Pressure	Max 7 bar (105 psi)	
Flow Capacity (Cv)	0.9	
Operating Temperature	-20°C ~ +70°C *	
Pneumatic Connections	PT(Rc) 1/4 or NPT 1/4	
Hysteresis	Within 0.1 bar	
Body Material	Aluminum die-cast	
Weight	0.6 kg	0.8 kg

LU	Actioning type	Pneumatic Connections	Operating Temperature
	<input type="checkbox"/> S : Single acting <input type="checkbox"/> D : Double acting	<input type="checkbox"/> 1 : PT 1/4 <input type="checkbox"/> 2 : NPT 1/4	<input type="checkbox"/> 1 : -20 ~ +70°C (standard) <input type="checkbox"/> 2 : -20 ~ +120°C (high temp.)

PG POWER-GENEX
<http://www.power-genex.com>

DRAWN	NAME	SIGNATURE	PROJ : 3rd
CHECKED	Kim. D. H		SCALE : 1:1
APPROVED	Kim. K. W		SIZE : A3
DATE			
QUANTITY		DIMENSION : mm	
		SHEET 1 OF 1	

TITLE :	LOCK UP VALVE
PRODUCT NAME :	
MODEL :	LUV
DWG NO.	PG-LUV-01
REV. NO.	A