

Valve Body	Aluminum (A6061), SUS316
Valve Head	Aluminum die-casting
Spool	Aluminum, SUS316
Armature	Stainless steel 430F
Spring	Stainless steel
Seal	NBR
Screws	Stainless Steel

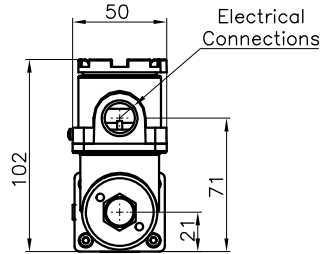

-SPECIFICATIONS

Model	ESV SS
Operating Air Pressure	1.5 - 10 bar
Air Supply (Max.)	15 bar
Operating Voltage / Power	AC 110V : 6.1 VA AC 220V : 3.8 VA DC 24V : 3.4 W
Voltage Tolerance	±10%
Frequency	50Hz / 60Hz
Explosion Proof Class	Ex d IIC T6/T5
Operating Ambient Temperature	T6 : -30°C ~ +60°C T5 : -30°C ~ +80°C
Flow Capacity (Cv)	0.9
Mounting Configuration	NAMUR or screw interface
Pneumatic Connections	NPT 1/4 (other on request)
Electrical Connection	PF(G) 1/2 or NPT 1/2
Coil Insulation Grade	Class F **
Duty Cycle	100%
Weight	1.9 kg

-SPECIFICATIONS

Model	ESV - S
Operating Air Pressure	1.5 - 10 bar
Air Supply (Max.)	15 bar
Operating Voltage / Power	AC 110V : 6.1 VA AC 220V : 3.8 VA DC 24V : 3.4 W
Voltage Tolerance	±10%
Frequency	50Hz / 60Hz
Explosion Proof Class	Ex d IIC T6/T5
Operating Ambient Temperature	T6 : -30°C ~ +60°C T5 : -30°C ~ +80°C
Flow Capacity (Cv)	0.9
Mounting Configuration	NAMUR or screw interface
Pneumatic Connections	PT(Rc) 1/4 or NPT 1/4
Electrical Connection	PF(G) 1/2 or NPT 1/2
Coil Insulation Grade	Class F **
Duty Cycle	100%
Weight	0.9 kg

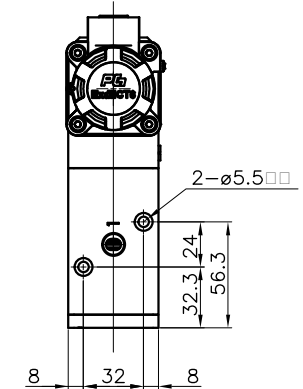
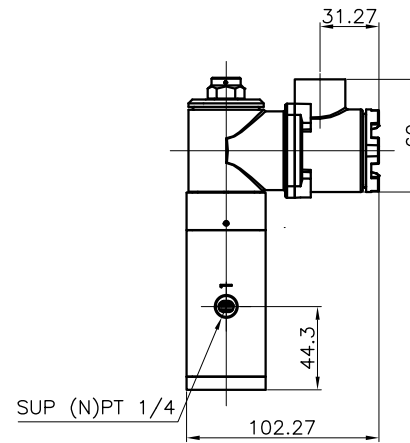
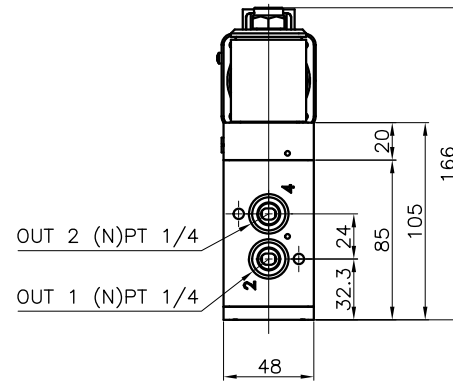
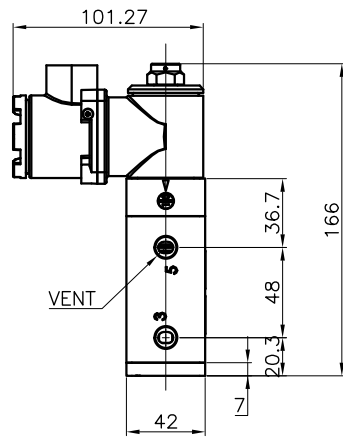

ESV	Operating Type	Operating Voltage	Electrical Connections
	□ S : Single Coil Type	□ A220 : AC 220V □ A110 : AC 110V □ D24 : DC 24V	□ AL □ P : PT(Rc) 1/4 - PF(G) 1/2 □ N : NPT 1/4 - NPT 1/2 □ SUS316 □ P : NPT 1/4 - PF(G) 1/2 □ N : NPT 1/4 - NPT 1/2

PG POWER-GENEX http://www.power-genex.com				TITLE : SOLENOID VALVE SINGLE	
DRAWN	NAME	SIGNATURE	PROJ : 3rd	PRODUCT NAME :	
CHECKED	Kim. D. H		SCALE : 1:1	MODEL :	
APPROVED	Kim. K. W		SIZE : A3	ESV	
DATE				DWG NO.	
QUANTITY			DIMENSION : mm	PG-ESV-01	
			SHEET 1 OF 1	REV. NO. A	